

Owners Manual

Model #ABS1019

GLUTE LIFT™

ELITE

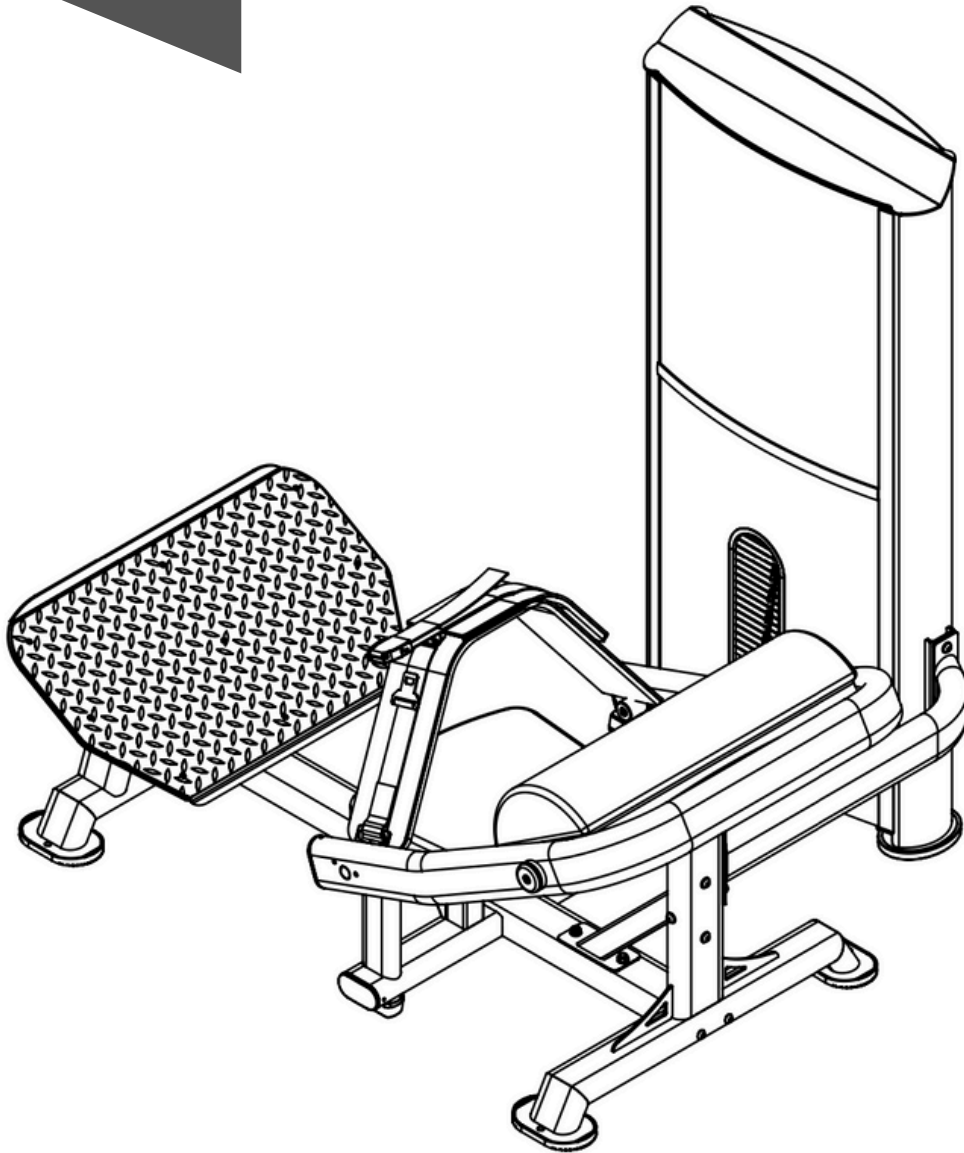

We Change Lives from the Core®

Warranty information inside



TABLE OF CONTENTS

Important Safety Instructions.....	pg. 03
Instructions.....	pg. 04
Parts List.....	pg. 05
Exploded View.....	pg. 06
Hardware Kit.....	pg. 07
Measurement Guide.....	pg. 08
Assembly Instruction.....	pg.09
Assembly.....	pg.10
General Maintenance Schedule.....	pg.19
General Maintenance Information.....	pg.20
Training Tips.....	pg.21
Warranty.....	pg.22



CAUTION

Read all precautions and instructions in the manual before using this equipment.

IMPORTANT SAFETY INSTRUCTIONS



Before beginning any fitness program, you should obtain a complete physical examination from your physician. When using exercise equipment, basic precautions should always be taken, including the following:

1. Read all instructions before using the equipment. These instructions are written to ensure your safety and to protect the unit.
2. Use the equipment only for its intended purpose as described in this guide. Do not use accessory attachments that are not recommended by the manufacturer, as such attachments might cause injuries.
3. The product should only be used on a level surface and with 0.5 meters space around the product. Do not store the equipment outdoors.
4. The equipment is not intended for use by children under the age of 16. Children over the age of 16 should use the equipment with adult supervision.
5. Do not overexert yourself or work to exhaustion. Do not attempt to lift more weight than you can control safely. If you feel any pain or abnormal symptoms, stop your workout immediately and consult your physician.
6. This equipment is not intended to be used as or with medical apparatus/instruments.
7. Never operate the unit when it has been dropped or damaged. Never drop or insert anything into any opening in the equipment. Always check the unit and its cables before each use. Make sure that all fasteners and cables are secure and in good working condition. Frayed or worn cables can be dangerous and may cause injury. Periodically check these cables for any indication of wear. Keep hands, limbs, loose clothing and long hair well out of the way of moving parts.
8. Be careful when getting on or off the equipment.
9. Wear proper exercise clothing and shoes for your workout, no loose clothing.

Personal Safety During Assembly

Read each step in the assembly instructions and follow the steps in sequence. Do not skip ahead. If you skip ahead, you may learn later that you have to disassemble components and that you may have damaged the equipment.

Assemble and operate the equipment on a solid, level surface. Locate the unit a few feet from walls or furniture to provide easy access. The equipment is designed for your enjoyment, and by following these precautions, we believe you will enjoy your new equipment and the many benefits it will provide.



INSTRUCTIONS

Before beginning assembly, please take the time to read instructions thoroughly. Please use the various lists in this manual to make sure that all parts have been included in your shipment. If parts are found to be missing, please contact either your authorized dealer or us directly and reference the part name and number from the parts list. Use only our replacement part when servicing. Failure to do so will void your warranty and could result in personal injury.

The equipment is designed to provide the smoothest, most effective exercise motion possible. After assembly, you should check all functions to ensure correct operation. If you experience problems, first recheck the assembly instructions to locate any possible errors made during assembly. If you are unable to correct the problem, call your authorized dealer or contact us directly to continue troubleshooting. Be sure to have the serial number, related part names and numbers and your manual handy when calling. Do not continue assembly, or use the equipment until all parts have been accounted for and troubleshooting is complete.

Tools Required



Ratchet Wrench and Socket



Adjustable Wrench

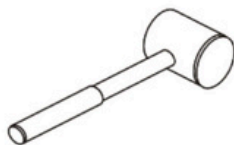

Rubber Mallet



Hex Key Wrench set

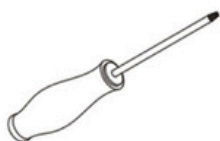

Phillips Screwdriver

PARTS LIST



NOTE: SOME OF THESE PARTS MAY COME PRE-INSTALLED

1	Upright Frame		1	34	Front Cover Strip	32*25*3*1364	2
2	Base Frame		1	35	Plastic Strip	10*8*2.5*980	1
3	Rear Upright Frame		1	36	Cover Strip	25*12*564	2
4	Supporting Frame		1	37	Φ95 Pulley	Φ95*24	3
5	Base Connection Frame		1	38	Foot Pad	169*109*16	4
6	Back Connection Frame		1	39	83X44.5 Bumper	83*44.5*25.4	4
7	Arm		1	40	PT50*100 Flat End Cap	PT50*100*2.5	3
8	Pulley Holder		1	41	O-shape Ring	Φ19*1.8	2
9	Belt A		1	42	Joint Bearing	S112TK	1
10	Belt B		1	43	Bearing	6005ZZ	4
11	Shaft	Φ25*845*M8	1	44	Thin Nut	M20*1.5	1
12	Front Upper Cover	630*605*3	1	45	Hex Screw	M6*6	8
13	Front Bottom Cover	734*605*3	1	46	Hex Flat Screw	M8*6	5
14	Cable	Φ6*2680	1	47	Cross Head Screw	M6*15	20
15	Curved Back Pad	700*280*110	1	48	Hex Countersunk Bolt	M5*10	9
16	Seat Pad	360*460/400*70	1	49	Hex Countersunk Bolt	M8*15	8
17	Pedal	770*445*3	1	50	Hex Bolt	M10*100	1
18	Connection Plate	160*50*8	1	51	Hex Bolt	M10*50	1
19	Sleeve	Φ38*Φ21*43	2	52	Hex Pan Head Bolt	M12*45	1
20	Shaft End Cap	Φ56*Φ25.2*11	2	53	Flat Washer	Φ13.5*Φ24*2.5	2
21	SKG Weight Stacks	450*100*16.5	17	54	Nut	M12	1
22	Top Plate	280*90*66	1	55	Hex Pan Head Bolt	M10*140	2
23	Magnetic Pin	Φ8*80	1	56	Hex Pan Head Bolt	M10*130	2
24	Guide Rod Bushing	Φ30*Φ20.2*30	2	57	Hex Pan Head Bolt	M10*120	2
25	PVC Foot Pad	169*129*16	2	58	Hex Pan Head Bolt	M10*70	2
26	Φ10 iron bushing	Φ18*Φ14*Φ10.1*6	2	59	Hex Pan Head Bolt	M10*45	3
27	Hex Perforated Bolt	M20*1.5*45	1	60	Hex Pan Head Bolt	M10*30	2
28	Φ18 Cable Terminal	Φ18*Φ6*45	1	61	Hex Pan Head Bolt	M10*25	16
29	Bumper	Φ55*Φ20.5*50	2	62	Hex Pan Head Bolt	M10*20	2
30	Guide	Φ20*1318*M10	2	63	Carriage Bolt	M10*65	2
31	17+1 selector rod	Φ25*398	1	64	Flat Washer	Φ11*Φ20*2	34
32	Back Cover	713*605*3	2	65	Nut	M10	13
33	Back Cover Strip	32*25*3*1420	2				



EXPLODED VIEW

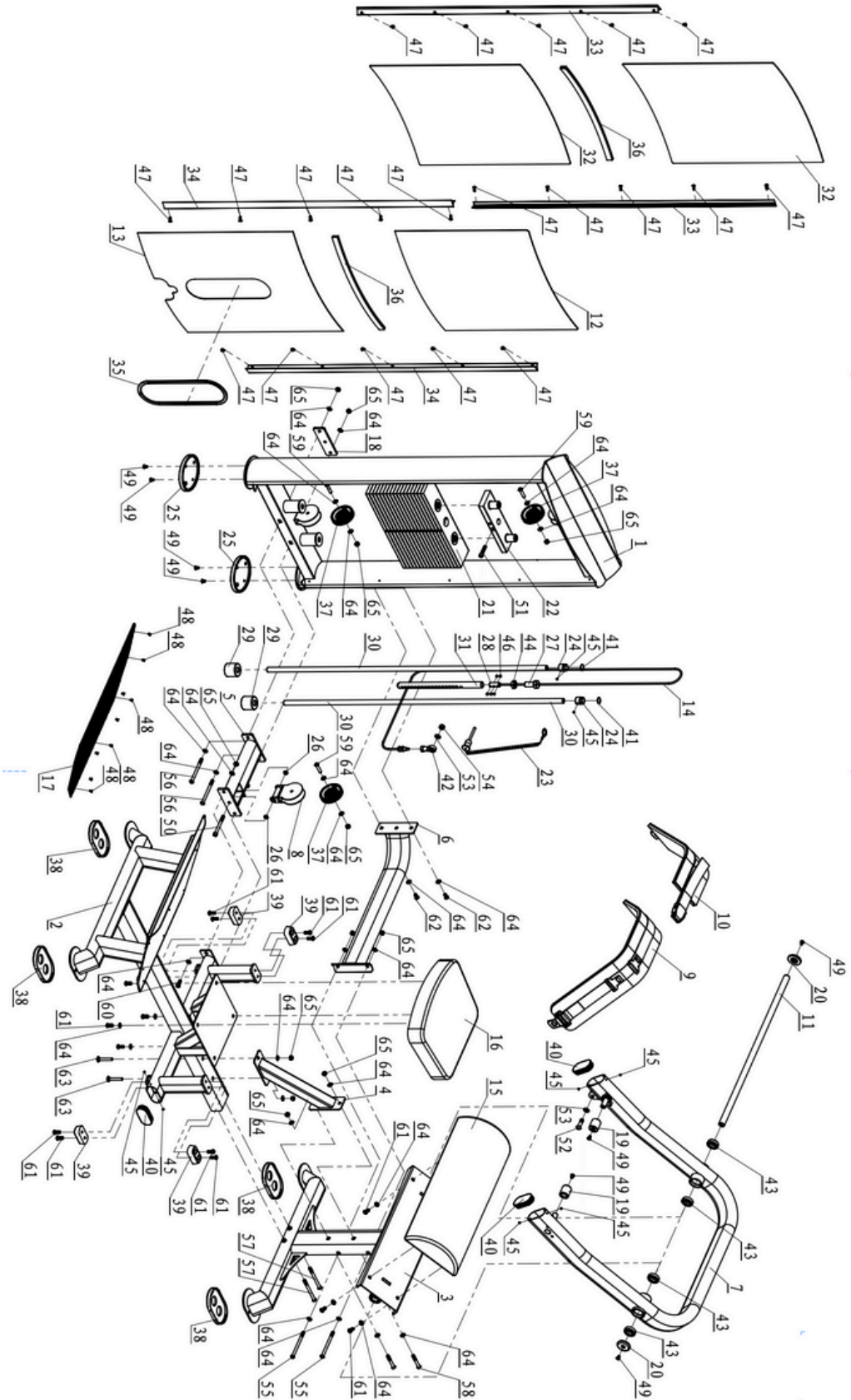

HARDWARE KIT



HARDWARE PACK (1/3)

GLUTE LIFT ELITE
GH155



No. 55 M10X140 (2)



No. 56 M10X130 (2)

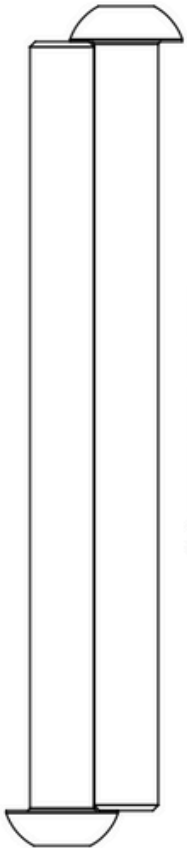

No. 57 M10X120 (2)

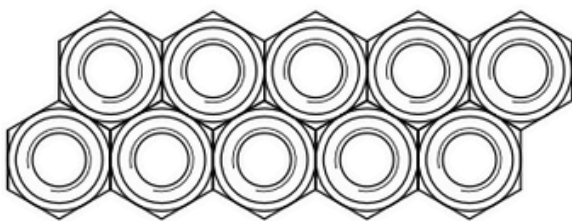

No. 65 M10 Nut (10)

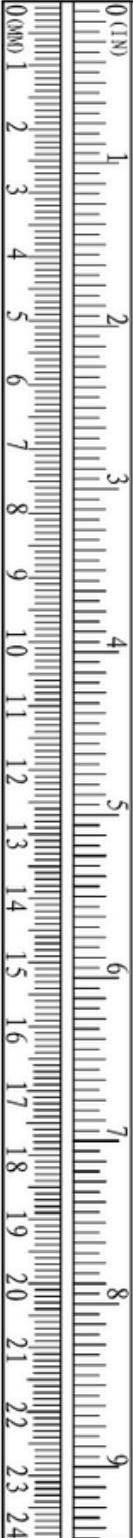



HARDWARE KIT

HARDWARE PACK (2/3)

GLUTE LIFT ELITE
GHT55

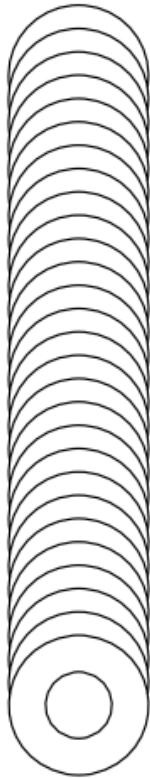

No. 64 \varnothing 10 Washer (28)

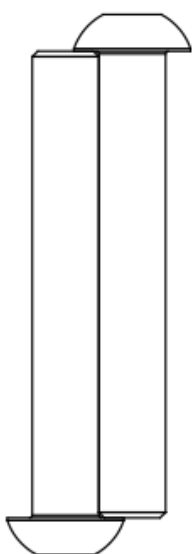

No. 58 M10X70 (2)

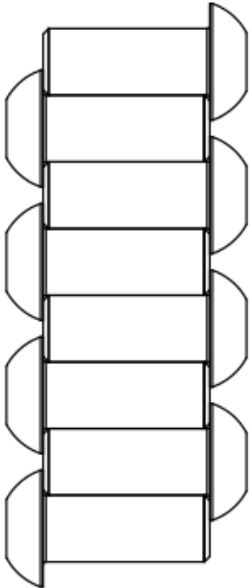

No. 61 M10X25 (8)

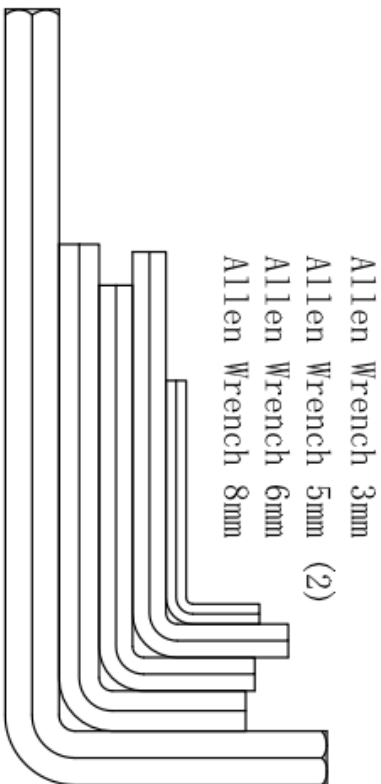

Allen Wrench 3mm
Allen Wrench 5mm (2)
Allen Wrench 6mm
Allen Wrench 8mm

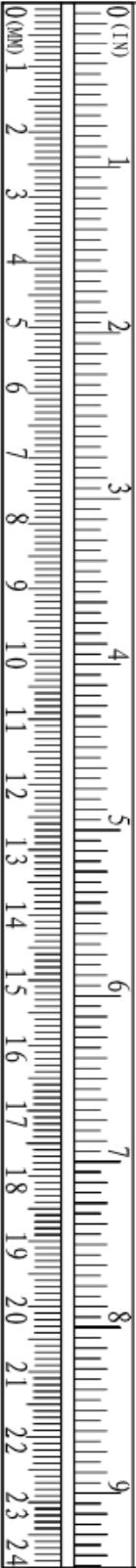



HARDWARE KIT

HARDWARE PACK (3/3) GLUTE LIFT ELITE GHT55

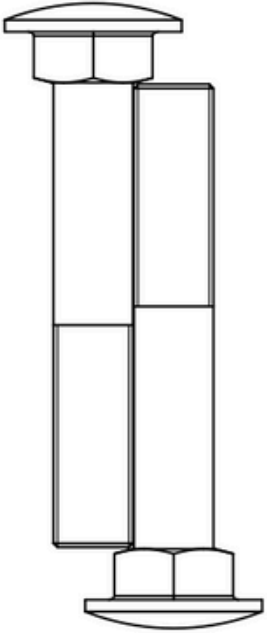

No. 63 M10X65 (2)

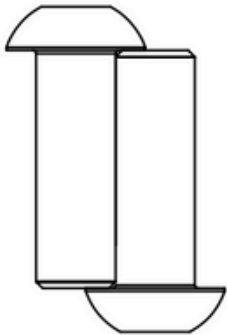

No. 60 M10X30 (2)

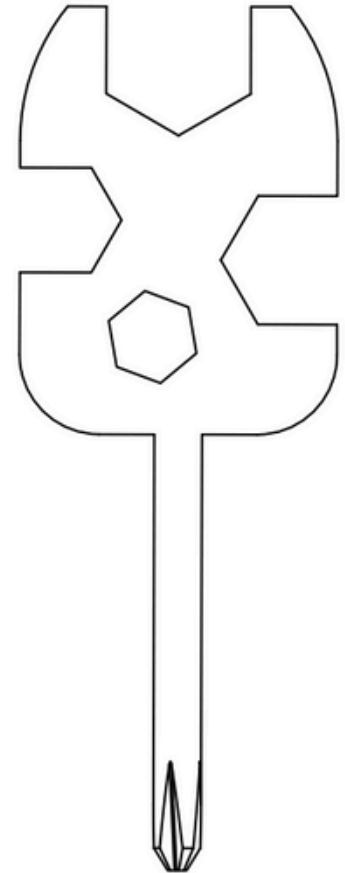

Universal Wrench

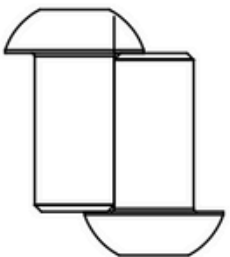

No. 62 M10X20 (2)

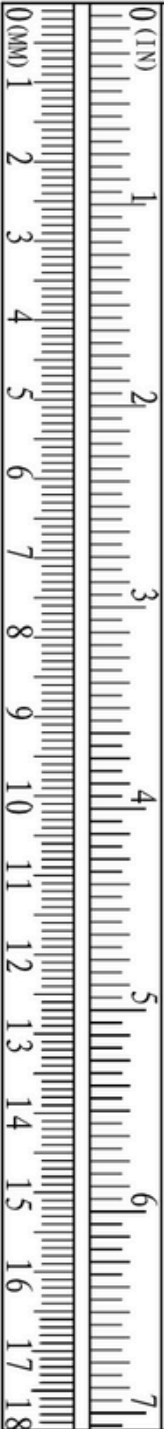



MEASUREMENT GUIDE

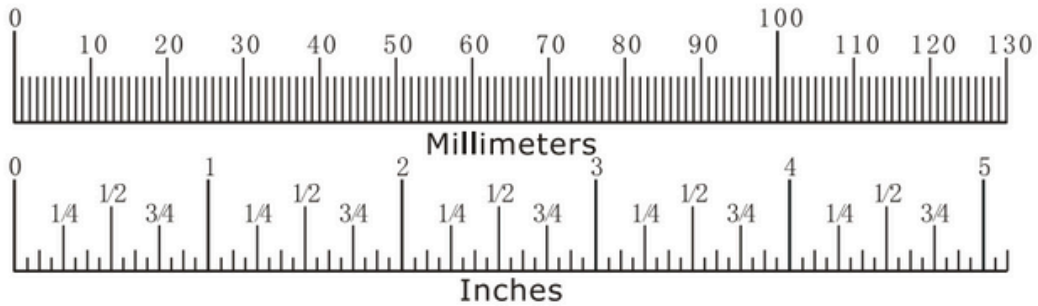
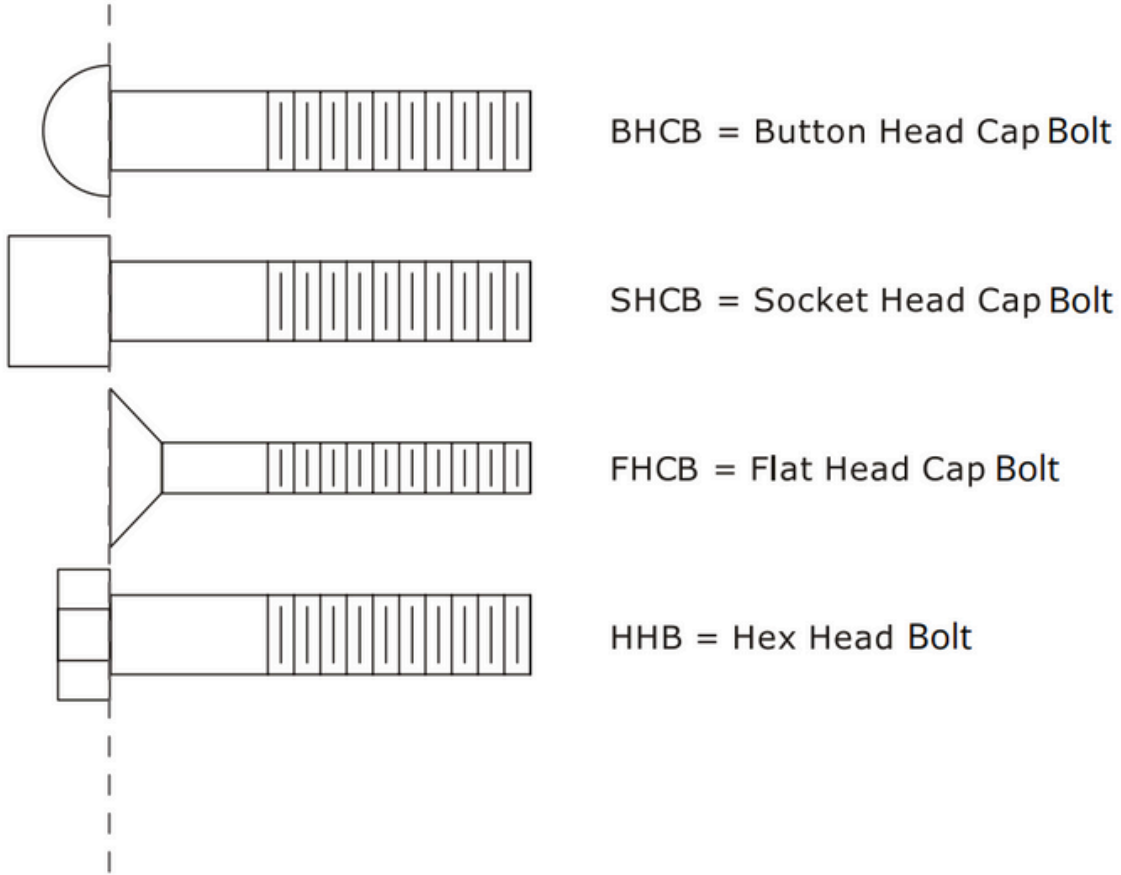

Diameter of bolt (mm/inch)	M6(1/4")	M8(5/16")	M10(3/8")	M12(1/2")	M16(5/8")
Tightening torque (N.m)	9~12	22~30	45~59	78~104	193~257
Operational methods for an adult	The strength of the wrist	The strength of the wrist and forearm	The strength of the entire arm	The strength of the arm and upper body	with all strength

ASSEMBLY INSTRUCTION



Assembly of the equipment takes professional installers about 1.5 hours. If this is the first time you have assembled this type of equipment, plan to spend more time. If you are in doubt about any part of this assembly, we recommend you contact a professional installer to complete the assembly. You may find it quicker, safer, and easier to assemble this equipment with the help of an assistant, as some components may be large, heavy or awkward to handle alone. It is important that you assemble your product in a clean, clear, uncluttered area. This will enable you to move around the product while you are fitting components and reduce the possibility of injury during assembly or damage to the area or equipment.



Note

As with any assembled part, proper alignment and adjustment is critical. While tightening the fasteners, be sure to leave room for adjustments. Do not fully tighten the fasteners until instructed to do so. Be careful to assemble the components in the sequence presented in this guide.

Training Area and Free Area

88 in / 223 cm

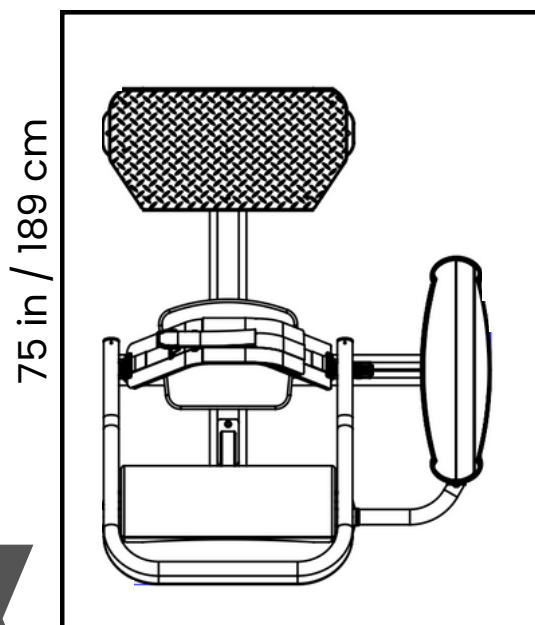

Free Area

Please allow for free area beyond the training area of 24 in / 60 cm on all sides of the unit to ensure that the training area is not impeded.

Specifications

Maximum Wt. Capacity: 415 lbs / 190 kg

Maximum User Weight: 415 lbs / 190 kg

Product Total Surface: 64*51 in / 162.5*129 cm



ASSEMBLY

STEP 1

1. Loosen the Guide Rod Bushings (#24) to allow the Guide Rods (#30) to tip forward. Remove the Guide Rod Bushings (#24) and set aside to build the weight stack.
2. Extract the Weight Stack pin (#23) from the weight plates and then remove Weight Stack Top Plate (#22) Assembly from the Guide Rods (#30) and set aside with the Guide Rod Bushings (#24).

Please note the top plate and cable will come attached and will be temporarily removed to build the weight stack.

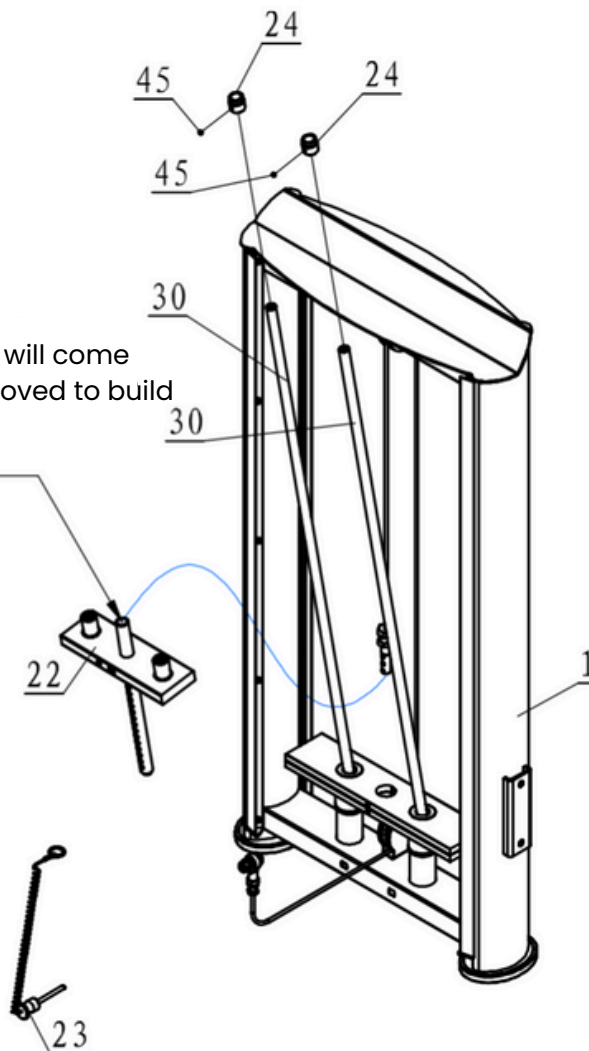



ASSEMBLY

STEP 2

1. Build the weight stack using 15 Weight Plates (#21). Make sure that the round plastic sleeve of the weight stack guide inserts are facing upwards.
2. Reinstall the Weight Stack Top Plate Assembly (#22) onto the Guide Rods (#30) and then reinstall the Guide Rod Bushings (#24) and then secure the Guide Rods (#30) into the frame by locking the set screws in the Guide Rod Bushings (#24) up into position. Reinstall the weight stack pin (#23) as well.
3. Remove the Pulley (#8) [JOEY; please add a '8' pointing to the pulley on the top of part 5 and a '14' pointing to the cable.] to thread the Cable (#14) under the Pulley (#8) and then reattach the pulley to the Base Connection Frame (#5). DO NOT over tighten the pulley—it should spin freely.
4. Attach the Base Connection Frame (#5) to the Upright Frame/Weight Stack (#1) using:

- 1 Connection Plate (#18)
- 2 M10*70 Hex Bolts (#58)
- 4 Flat Washers $\Phi 11 * \Phi 20 * 2$ (#64)
- 2 M10 Nuts (#65)

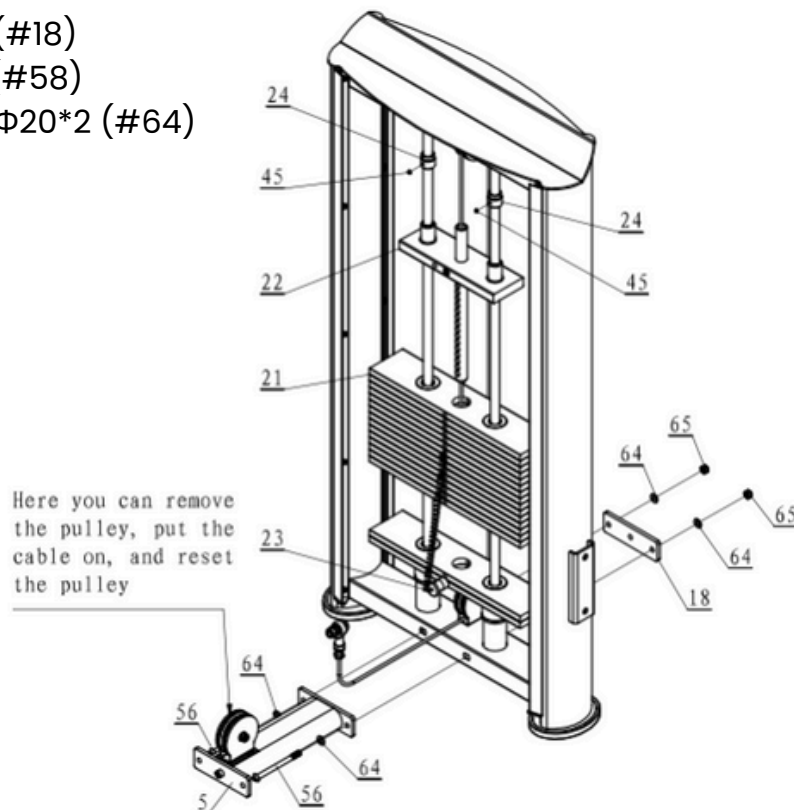



ASSEMBLY

● STEP 3

1. Install the Front Bottom Cover (#13) by sliding it down the mount tracks. Next slide the Cover Strip (#36) down to sit atop the Front Bottom Cover (#13). Finally slide the Front Upper Cover (#12) down until it touches the Cover Strip (#36).

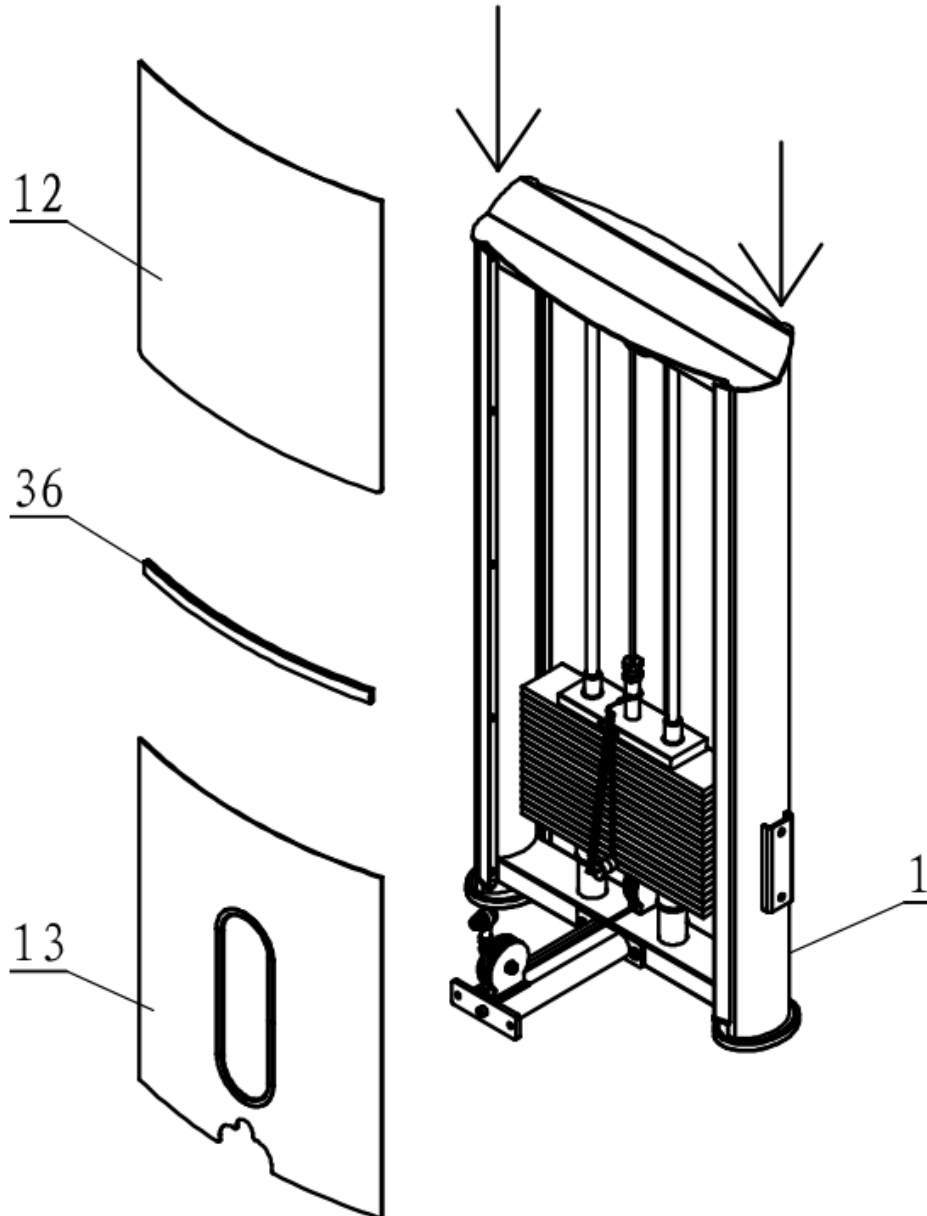



ASSEMBLY

STEP 4

1. Attach the Base Frame (#2) and the Rear Upright Frame (#3) using:
 - 2 M10*120 Hex Bolts (#57)
2. Attach the Supporting Frame (#4) to the Base Frame ASSY (#2 & #3) using:
 - 2 M10*65 Carriage Bolts (#63) - Bottom
 - 2 M10*70 Hex Bolts (#58) - Side
 - 6 Flat Washers $\Phi 11 \times \Phi 20 \times 2$ (#64)
 - 4 M10 Nuts (#65)

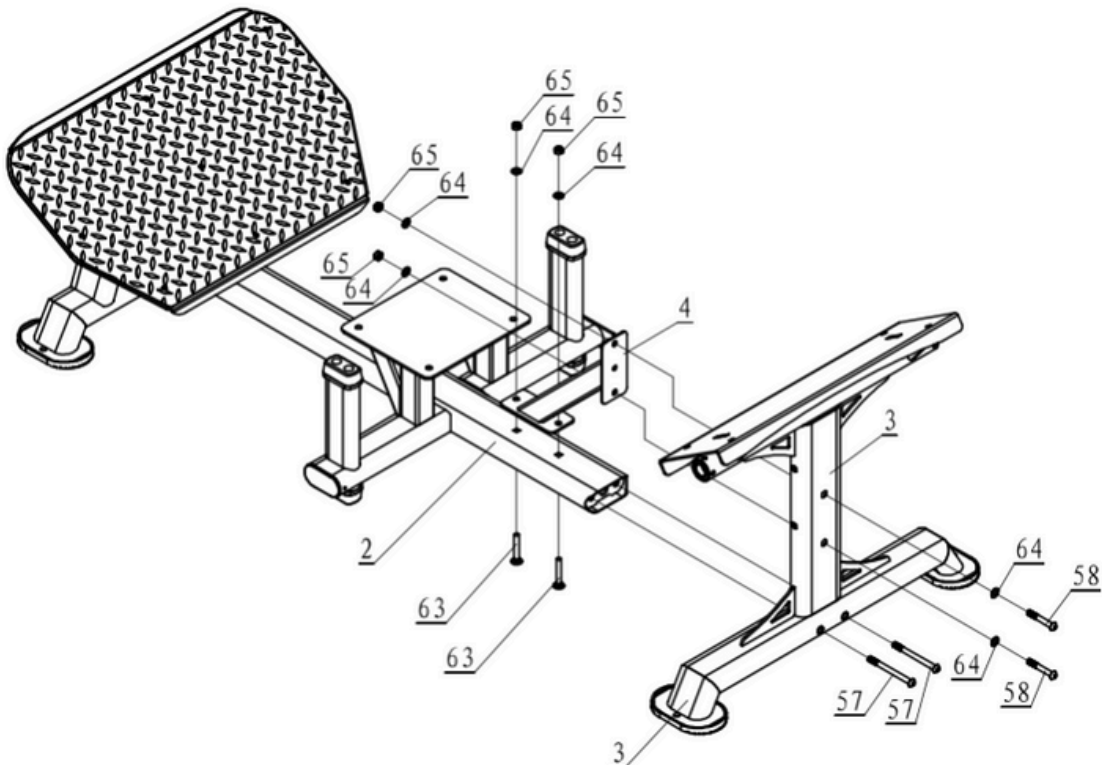



ASSEMBLY

STEP 5

1. Attach the Back Connection Frame (#6) to the Upright Frame ASSY (#1) using:
 - 2 M10*20 Hex Bolts (#62)
 - 2 Flat Washers $\Phi 11*\Phi 20*2$ (#64)
2. Attach the Base Frame ASSY (#2 & #3) to the Upright Frame ASSY (#1) using:
 - 2 M10*140 Hex Bolts (#55)
 - 2 M10*30 Hex Bolts (#60)
 - 8 Flat Washers $\Phi 11*\Phi 20*2$ (#64)
 - 4 M10 Nuts (#65)

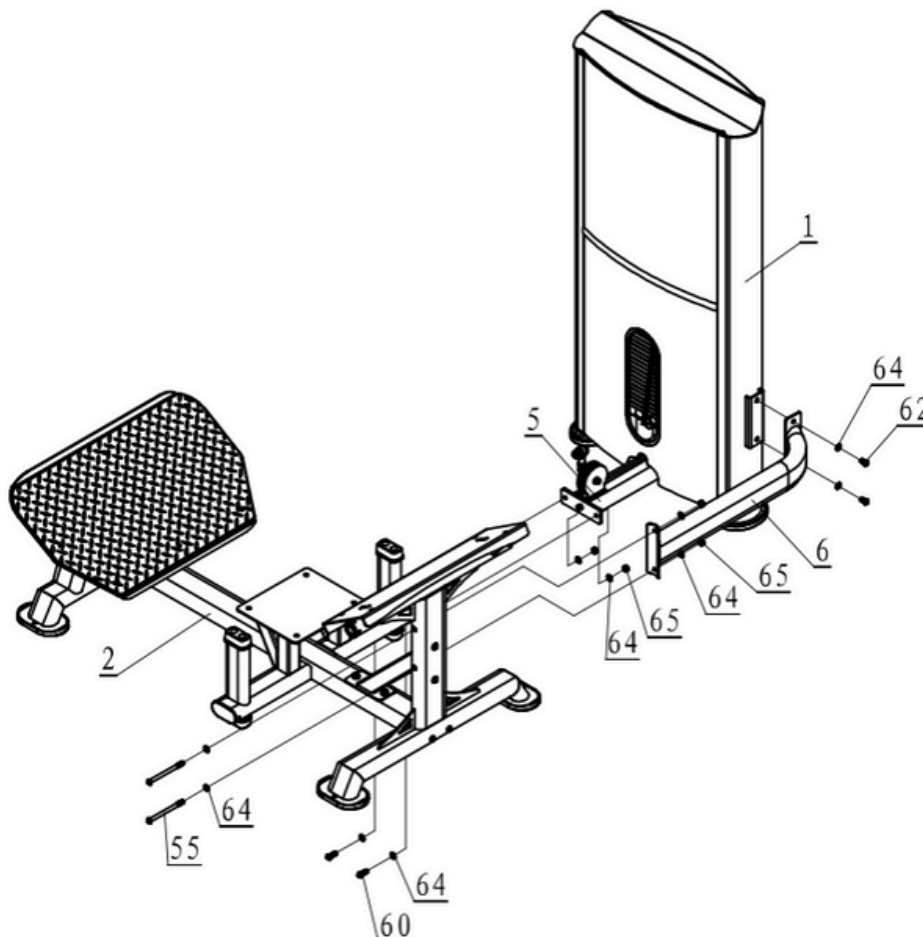



ASSEMBLY

● STEP 6

1. From the Arm Assembly (#7), unscrew the M6*15 Cross head Screws (#49) and set aside with the 2 Shaft End Caps (#20) and the Shaft (#11) to be reassembled on the Main ASSY in Step 7.

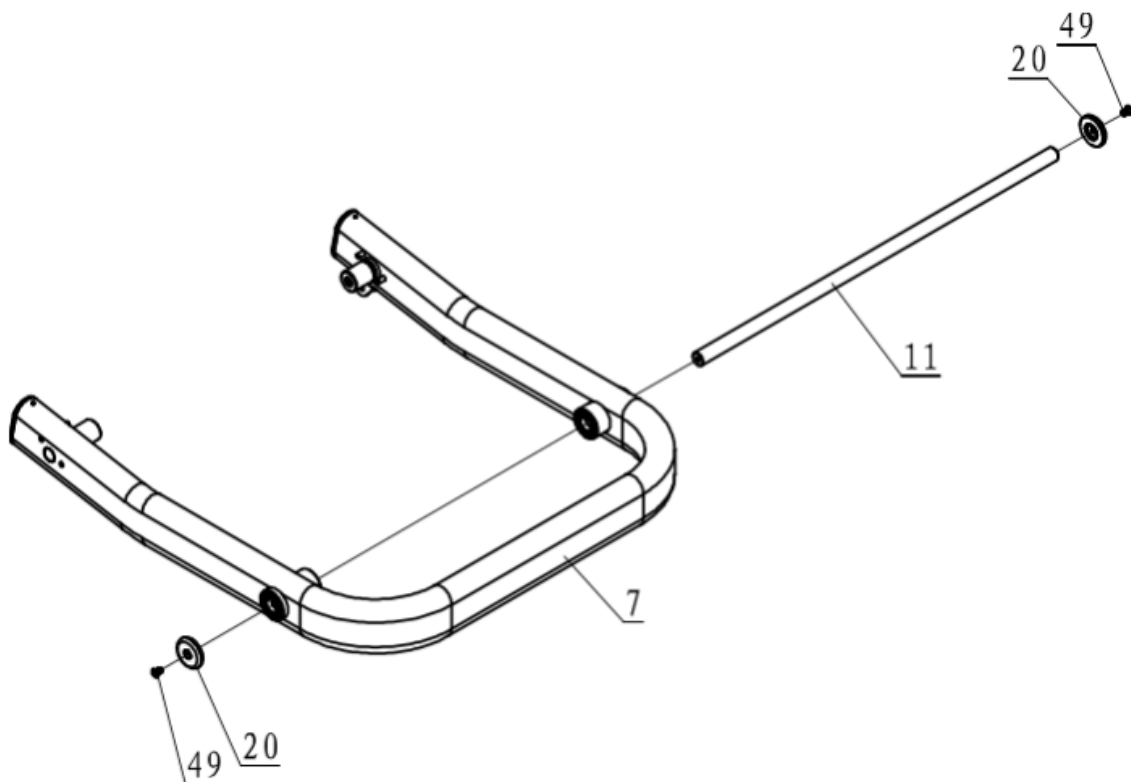



ASSEMBLY

STEP 7

1. Attach the Arm Assembly (#7) to the Rear Upright Frame (#3) by threading the Shaft (#11) back into the Arm Assembly (#7) and through the Rear Upright Frame (#3) then securing with the parts set aside in Step 6:
 - 2 Shaft End Caps (#20)
 - 2 M6*15 Cross head Screws (#49)
2. Remove the anchor hardware (1 M12*45 Hex Bolt (#52), 2 Flat Washers $\Phi 13.5 \times \Phi 24 \times 2.5$ (#53), and 1 M12 Nut (#54)) from the weight stack side of the Assembly Arm (#7).
3. Attach the Cable (#14) to the Arm Assembly (#7) with the hardware removed in step 7.2.
4. Attach the Seat Pad (#16) to the Frame ASSY (#1) using:
 - 4 M10*25 Hex Bolts (#61)
 - 4 Flat Washers $\Phi 11 \times \Phi 20 \times 2$ (#64)

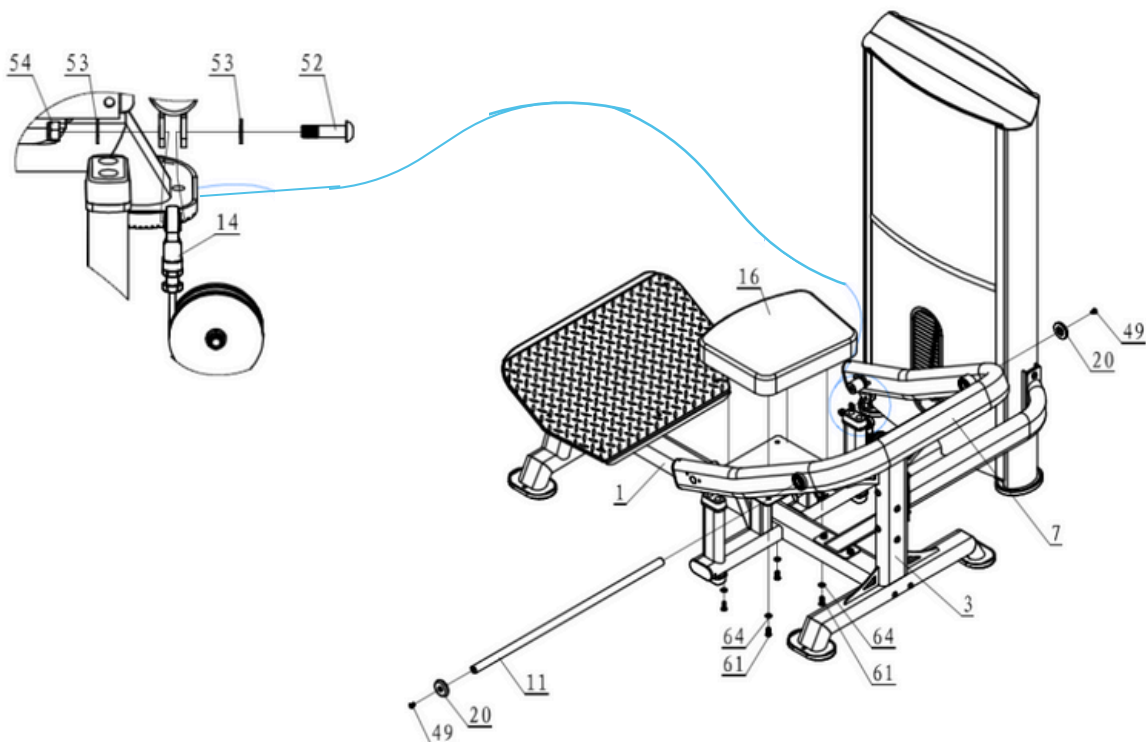



ASSEMBLY

STEP 8

1. Remove the 2 M8*15 Countersunk Bolts (#49) and the Sleeves (#19) from both sides of the Arm Assembly (#7).
2. Attach Belt A (#9) and Belt B (#10) to the posts on either side of the Arm Assembly (#7) and then secure in place using the parts from step 8.1. Do not over tighten.
2. Attach the Curved Back Pad (#15) to the top of the Rear Upright Frame (#3) using:
 - 4 M10*25 Hex Bolts (#61)
 - 4 Flat Washers $\Phi 11 \times \Phi 20 \times 2$ (#64)

Make sure that the metal buckle of the belt is just between the two limit posts and able to rock freely between them. Do not over tighten!

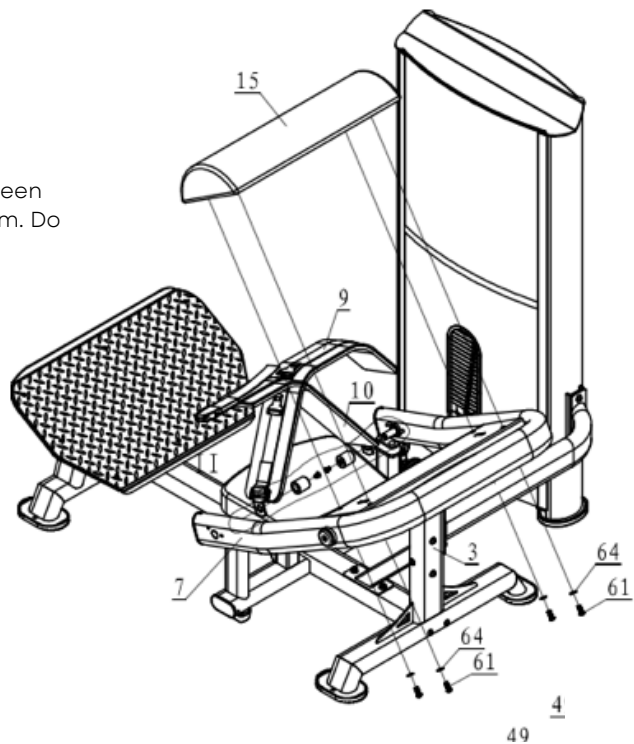
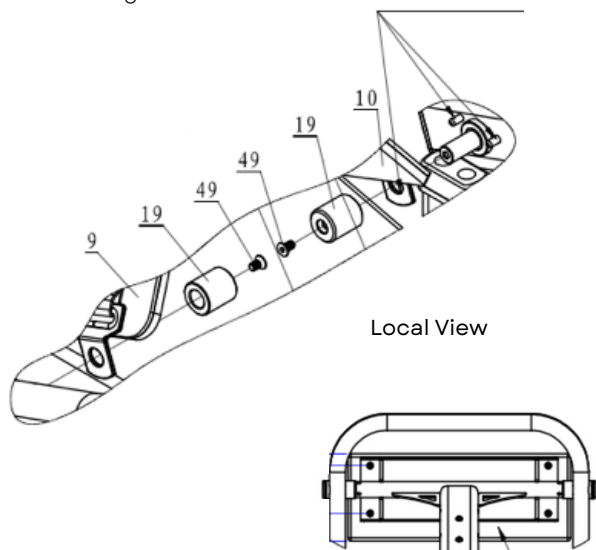

Note the direction when installing the semicircle pad
Note the distance from the hole to the edge



ASSEMBLY

STEP 9

1. Adjust the cable length to remove excess slack. This can be done at either end of the cable attachments. Once satisfied with the setting, lock into place with the thin hex nut on each end.
2. Install the first Back Cover (#32) by sliding it down the mount tracks on the back of the machine to the base. Next slide the Cover Strip (#36) down to sit atop the Back Cover (#32). Finally slide the second Back Cover (#32) down until it touches the Cover Strip (#36).

Unit is now ready to use safely.

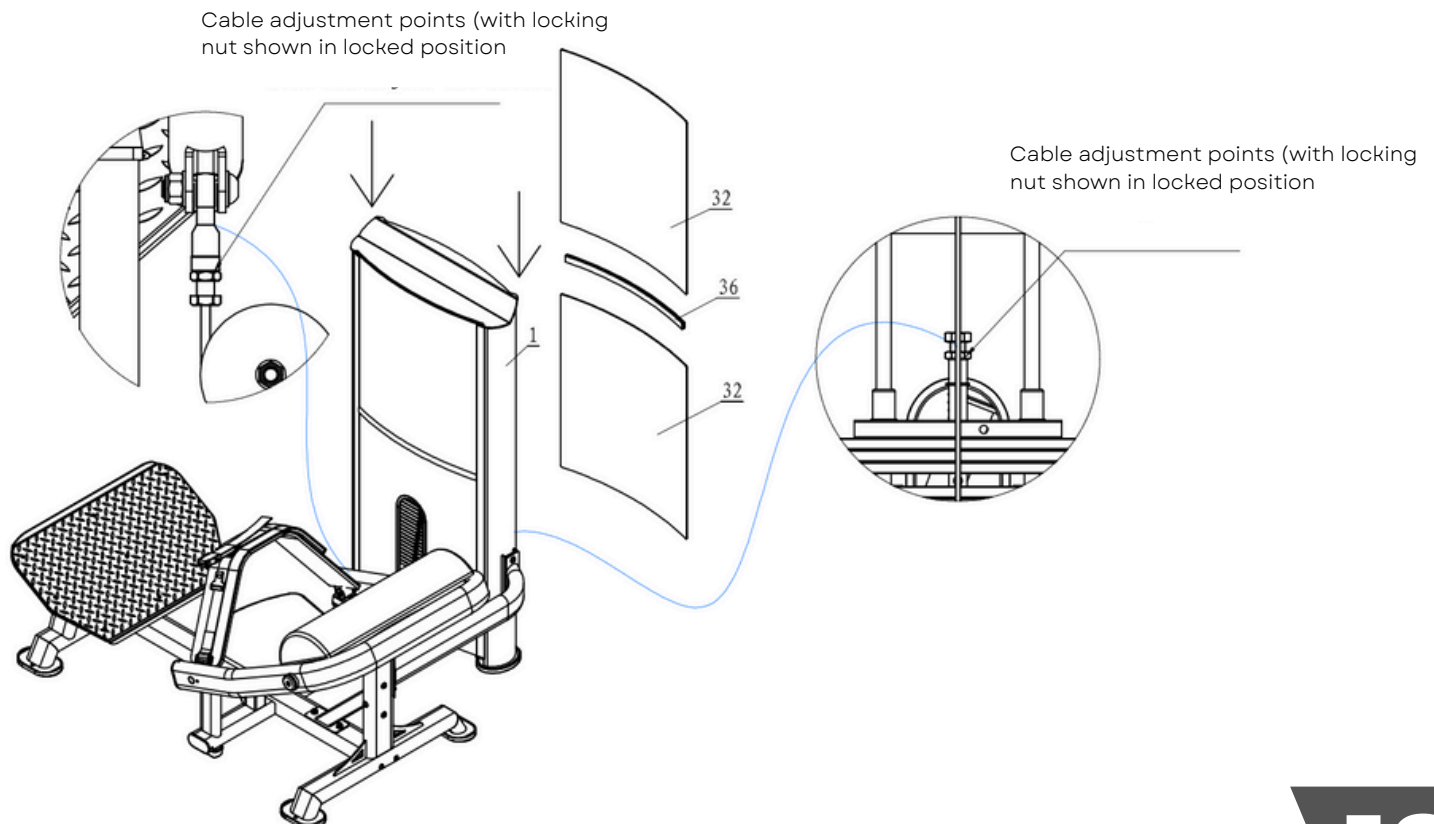

GENERAL MAINTENANCE SCHEDULE

ROUTINE	COMMERCIAL MAINTENANCE	HOME MAINTENANCE	LATEST DATE ENTRY						
Inspect; Links, Pull Pins, Snap Locks, Swivels, Weight Stack Pins	DAILY	WEEKLY							
Clean; Upholstery	DAILY	WEEKLY							
Inspect; Cables or Belts and their tension	DAILY	WEEKLY							
Inspect; Accessory Bars, and Handles	WEEKLY	3 MONTHS							
Inspect; All Decals	WEEKLY	3 MONTHS							
Inspect; All Nuts and Bolts, Tighten if needed	WEEKLY	3 MONTHS							
Inspect; Anti-Skid Surface	WEEKLY	3 MONTHS							
Clean & Lubricate; Guide Rods with a Teflon (PTFE) based lubricant (Superlube)	MONTHLY	3 MONTHS							
Lubricate; Seat Sleeves, Turcite Bushings, Linear Bearing	MONTHLY	3 MONTHS							
Clean and Wax; All Glossy Finishes	6 MONTHS	YEARLY							
Repack with Grease; Linear Bearings	6 MONTHS	YEARLY							
Replace; Cables, Belts and Connecting Parts	YEARLY	3 YEARS							

A fitness facility should have a regular maintenance schedule in place that this equipment can be added into. For personal, in home use, please follow the home maintenance schedule listed above.

GENERAL MAINTENANCE INFORMATION



Links, Pull-Pins, Snap Hooks, Swivels, Weight Stack Pins:

- Check all pieces for signs of visible wear or damage.
- Check springs in snap hooks and pull-pins for proper tension and alignment.
- If the spring sticks or has lost its rigidity, replace it immediately.

Upholstery:

- To ensure prolonged upholstery life and proper hygiene, all upholstered pads should be wiped down with a damp cloth after every workout.
- Periodically take the time to use a mild soap or an approved vinyl upholstery cleaner to deter the onset of cracking or drying. Avoid using any abrasive cleaners or cleaners not intended for use on vinyl.
- Replace ripped or worn upholstery immediately.
- Keep sharp or pointed objects clear of all upholstery.

Decals:

- Inspect and familiarize yourself with any safety warnings or other user information posted on each unit.

Nuts and Bolts:

- Inspect all nuts and bolts for any loosening and tighten if needed.
- Go through a re-tightening sequence periodically to ensure that all hardware is tensioned properly.

Anti-Skid Surfaces:

- These surfaces are designed to supply secure footing and need to be replaced if they appear worn or become slippery.

Belts and Cables:

- Visually inspect the belts and cables for fraying, cracking, peeling, or discoloration.
- While the machine is not in use, carefully run your fingers along the belt or cable to feel for thinning or bulging areas.
- Replace belts and cables immediately at the first signs of damage or wear. Do not use equipment until belts or cables have been replaced.

Belt and Cable Tension:

- Referring to the Owners Manual, when belts or cables are used check all bolts attachments to be sure they are properly attached.
- Check slack in cables and re-adjust cable tension if needed.

Seat Sleeves, Guide Rods:

- Before applying lubricant, wipe down applicable parts with a dust free rag.
- Lubricate seat sleeves and Guide Rods with a Silicon or Teflon based lubricant spray.

Linear Bearings:

- Referring to the Owners Manual carefully disassemble the bearing from its housing and place a finger full of light grease (lithium, super lube, etc.) into the inside of the bearing. Using your finger, press the grease into the ball-bearings and their tracks. Repeat until the ball-bearing tracks are full of grease. Insert the shaft back into the bearing and wipe off excess grease.

PLEASE KEEP THIS FOR YOUR RECORDS



TRAINING TIPS

Use this manual to guide you through the basic exercises you can perform on your equipment. To gain maximum results and avoid possible injury, consult a fitness professional to develop your complete exercise program.

Always consult your physician before starting any exercise program.

To be successful in your exercise program, it is important to develop an understanding of the basic principles of strength training. Now that you have your equipment, it is only natural that you want to get started immediately. First, determine a set of realistic goals and objectives for yourself. By deciding on an exercise plan that is right for you prior to starting, you will contribute significantly to your success.

Warm up properly before engaging in weight resistance training. Stretching, yoga, jogging, calisthenics or other cardiovascular exercise can help prepare your body for the heavier workload of lifting weights.

Learn how to perform the exercise correctly before using heavy weight. Correct form is important to avoid injury and to ensure that you work the proper muscle groups.

Know your limitations. If you are new to weight training or are embarking on an exercise regimen after a long layoff, start slowly and build foundational strength over a longer period of time.

Pay attention to your breathing. Exhale when you exert is a general rule of thumb. Never hold your breath.

GLUTE LIFT™

ELITE

Manufacturer's Limited Warranty

The manufacturer warrants that your Glute Lift™ Elite is free of defect in materials and workmanship and will, at its option, repair or replace any defective Glute Lift™ Elite that is returned to it. Except as described in the following sentence, all parts and components of the Glute Lift™ Elite are warranted from the original date of purchase as below:

Frame - 3 years

All other parts - 1 year

Cable - 6 months

Padding - 90 days

1. This warranty is valid only in accordance with the condition set forth below:
Normal wear and tear (including lost parts) are not covered by this warranty.
2. The warranty extends only to the original consumer purchaser and is not transferable. In addition, proof of purchase must be demonstrated. This warranty is void if the product has been subject to accident, misuse, abuse, improper maintenance or repair or unauthorized modification.
3. This limited warranty is the only written or express warranty given by the manufacturer. Any implied warranty of merchantability of fitness for a particular purpose on this product is limited in duration to the duration of this warranty. Some states do not allow limitations on how long an implied warranty lasts, so the above limitation may not apply to you.
4. Repair or replacement of the product (or, if repair or replacement is not feasible, a refund of the purchase price) is the exclusive remedy of the consumer under this warranty. The manufacturer reserves the right to remedy any warranty claims via parts and repair prior to replacement. The manufacturer shall not be liable for any incidental or consequential damages for breach of this warranty or any implied warranty on this product. Some states do not allow the exclusion or limitation of incidental or consequential damages, so the above limitation or exclusion may not apply to you.
5. This warranty gives you specific legal rights, and you may also have other rights which vary from state to state.

Procedure for Warranty Repairs or Replacement:

If warranty service is necessary, the original purchaser must either call or email for instructions.

Proof of Purchase will be required for all warranty claims.

Our phone number is: (866) 219-5335 x0 (outside the U.S. 1-908-879-2713 x0)

www.theabscompany.com

GLUTE LIFT™

ELITE

Thank you for purchasing the Glute Lift™ Elite. Our customer service staff is ready to help and to answer any questions. Our phone number is: (866) 219-5335 x-0
Parts@TheAbsCompany.com

Please call us if you have any questions.
Customer service staff can be reached
Monday to Friday from 9:00 AM to 5:00 PM Eastern Standard Time.

You can also send us an email, or visit our website
for additional customer service information.

Prior to calling or emailing, please have the following information ready:

- Customer Name and Address
 - Telephone Number
 - Proof of Purchase
- Product Model Number
 - Serial Number



We Change Lives from the Core®

The Abs Company, 8429 Lorraine Rd, Lakewood Ranch, FL 34202
1-866-219-5335 - www.TheAbsCompany.com
© 2022 The Abs Company. All Rights Reserved.

Protected under US and INTERNATIONAL Patents. Patent information available upon request.